



302/263 Franklin Street Melbourne VIC

1 1

Positioned directly opposite the iconic Queen Victoria Market and the green expanses of Flagstaff Gardens, this one bedroom, one bathroom apartment is soaked in northern sun and finished to elite standards throughout.

With luxury and lifestyle at the forefront, and appealing to market entrants and savvy investors, modern spaces reveal light-filled, open-plan living/dining, sleek kitchen flaunting Smeg appliances, stone surfaces and integrated fridge/freezer, split system heating/AC and private balcony.

A prized opportunity surrounded by the best Melbourne has to offer, a stone's throw to Flagstaff train station, RMIT, Melbourne University, and the finest cafes and restaurants in the area.

Price : \$ 265,000
Building Size : 31 sqm
View : <https://www.areal.com.au/sale/vic/inner-city/melbourne/residential/apartment/8062526>



Keith Chan
03 9818 8991



Kay Lim
03 8686 8388

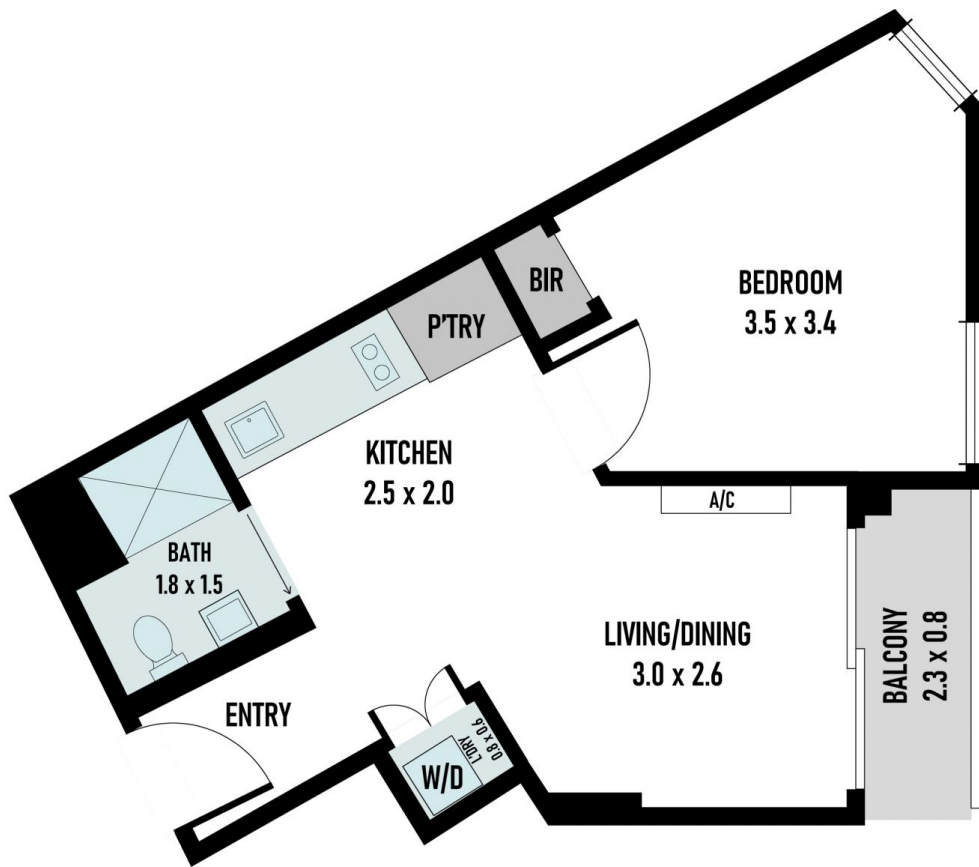

A/REAL

Scale in metres. Indicative only. All information contained herein is obtained from sources we believe to be accurate. We cannot guarantee its accuracy. You should make and rely on your own enquiries

