

404/25-29 Alma Road St Kilda VIC

2 🛏 2 🚿 1 🚗

"Where Luxury Meets Convenience"

Imagine a life coming home to luxurious surroundings, city views, and unforgettable hotel-style facilities, all only moments from St Kilda and Chapel Street, Melbourne's most iconic beach and lifestyle destinations!

Located in the prestigious Meridian building, this two bedroom, two bathroom apartment offers a spacious, light-filled sanctuary. Modern oak timber floorboards, architectural design, and high-end fittings create an ambiance of sophistication. The two bedrooms, both with built-in robes, offer comfortable spaces for relaxation. The master suite boasts a luxurious ensuite and a convenient study nook with views over the balcony. The second bedroom features floor-to-ceiling windows with balcony

**Price** : \$ 570,000

**View** : <https://www.areal.com.au/sale/vic/inner-city/st-kilda/residential/apartment/7955768>



**Linda Pan**  
03 8686 8388

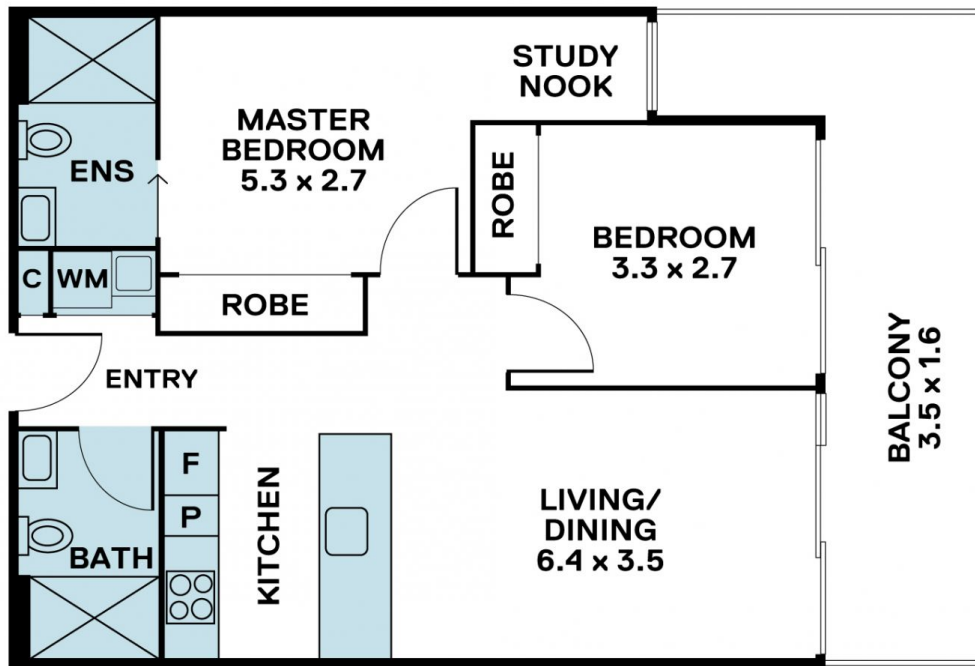

INTERNAL : 55m<sup>2</sup>  
 BALCONY : 13m<sup>2</sup>  
 TOTAL AREA : 68m<sup>2</sup>

**A/REAL**

Disclaimer "Scale in metres. Indicative only. All information contained herein is obtained from sources we believe to be accurate. We cannot guarantee its accuracy. You should make and rely on your own enquiries."

