



212/24 Oleander Drive Mill Park VIC

2 2 1

Perfectly positioned close to local cafes, shopping and transport options in the heart of South Morang's Centre this light-filled two-bedroom apartment offers an opportunity to first-home buyers, investors and downsizers alike! The impressive layout allows for both bedrooms and the living area to have direct access to the balcony through sliding doors - so you can walk out and take in the fresh air anytime!

This beautifully designed home has a modern open-plan layout, with stone bench tops, a European laundry, and a split air-conditioned living area.

You'll love cooking up a storm in the kitchen with a

[For full version visit the website](https://www.areal.com.au)

Type : Apartment

Price : \$ 365,000

View : <https://www.areal.com.au/sale/vic/north/mill-park/residential/apartment/7735226>



Justin Sciola
03 8804 5888



Ben Pellicori
03 8804 5888

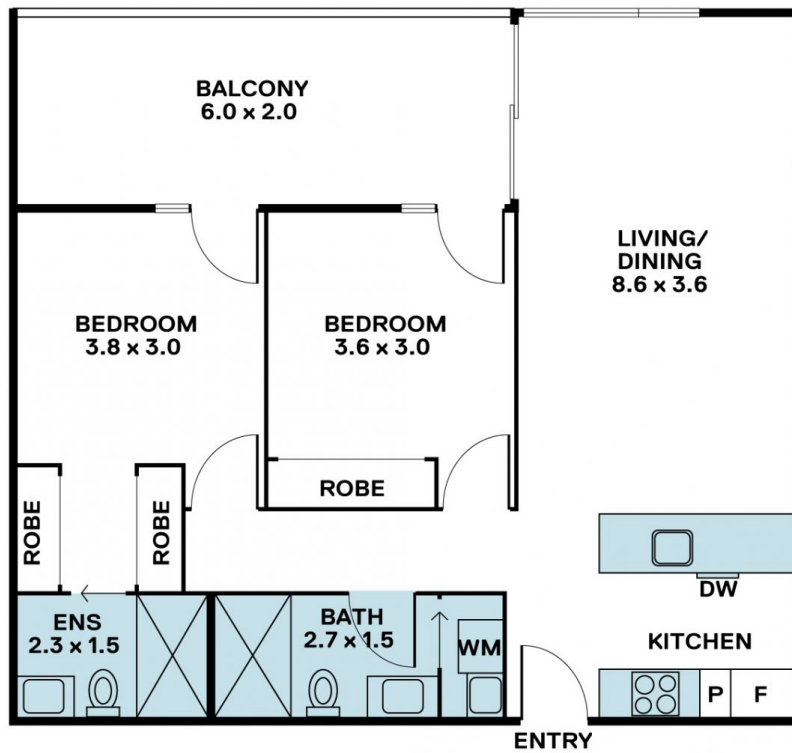

A/REAL

Disclaimer "Scale in metres. Indicative only. All information contained herein is obtained from sources we believe to be accurate. We cannot guarantee its accuracy. You should make and rely on your own enquiries."

