



3603/639 Lonsdale Street Melbourne VIC

1 1

Located within walking distance of Flagstaff Gardens, Crown Casino, excellent shopping and with the Southern Cross Station right at your doorstep this apartment is ideally located for a relaxed inner-city lifestyle.

Type : Apartment

Price : \$ 336,000

View : <https://www.areal.com.au/sale/vic/inner-city/melbourne/residential/apartment/7735187>

This beautifully designed home has a modern open-plan layout, a sleek black and white kitchen, a striking bathroom, and comfortable carpets in the living room and bedroom. From the living area and the bedroom, you can take in views over bustling streets below, or step out to the balcony to take in the breeze and capture a sunny day.

You'll love cooking up a storm in the the well-appointed kitchen with contemporary handleless cabinetry, lots of



Linda Pan
03 8686 8388

[For full version visit the website](https://www.areal.com.au)

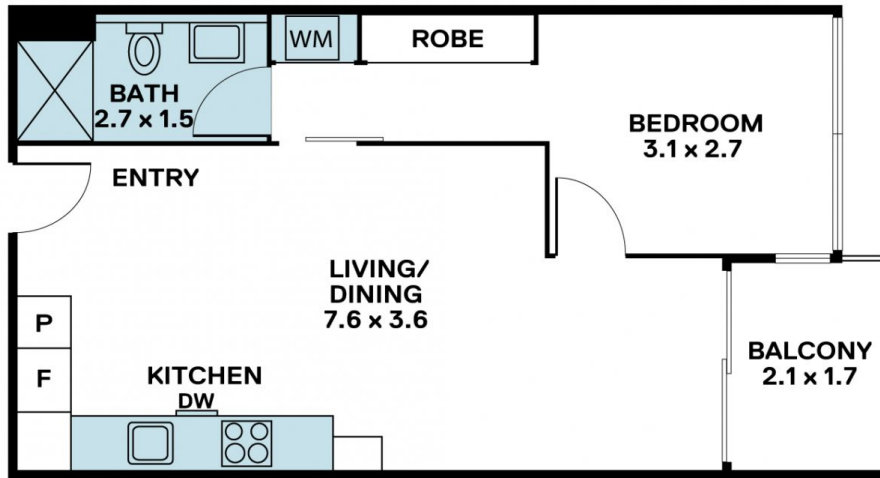

A/REAL

Disclaimer "Scale in metres. Indicative only. All information contained herein is obtained from sources we believe to be accurate. We cannot guarantee its accuracy. You should make and rely on your own enquiries."

