



221/311 Burwood Road Hawthorn VIC

1 1 1

When it comes to central and sought-after locations, it's hard to look past this modern unit set right in the heart of Hawthorn. A short walk from your front door will take you to cafes, shops and restaurants along with a host of entertainment options and public transport links that connect you directly to the Melbourne CBD.

There will be no shortage of house-hunters drawn to the easy-care one-bedroom, one-bathroom floorplan with all the contemporary features you could ever hope for. First-time buyers, couples and downsizers will adore the convenience of this idyllic abode while investors will be attracted to the set-and-forget appeal of this modern apartment.

[For full version visit the website](https://www.areal.com.au)

Type : Apartment

Price : \$ 370,000

View : <https://www.areal.com.au/sale/vic/east/hawthorn/residential/apartment/7735099>



William Shen
03 8686 8388



Dennis Shi
03 8686 8388

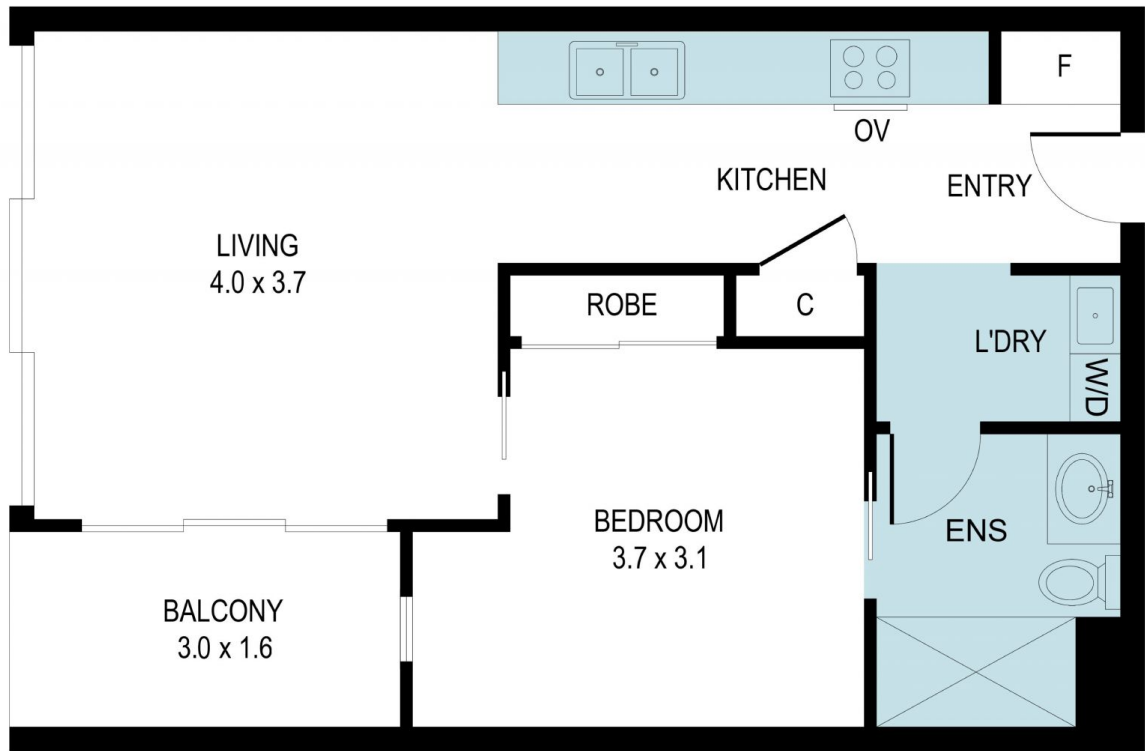

A/REAL

Disclaimer "Scale in metres. Indicative only. All information contained herein is obtained from sources we believe to be accurate. We cannot guarantee its accuracy. You should make and rely on your own enquiries."

