



## 1406/9 Waterside Place Docklands VIC

2 2 1

The quintessential Melbourne lifestyle could be all yours with this stylish Docklands apartment. A short stroll from your front door will take you to a selection of bustling cafes, renowned restaurants and picturesque parks along with Marvel Stadium, public transport links and the heart of the CBD.

This would make the ideal permanent residence, inner-city escape or low-maintenance investment to bolster your portfolio.

Walls of glass envelop the open-plan kitchen, dining and living space and perfectly frame the city views. At night, you can kick back and relax as the twinkling city lights

[For full version visit the website](https://www.areal.com.au)

**Type** : Apartment  
**Building Size** : 96 sqm  
**View** : <https://www.areal.com.au/sale/vic/inner-city/docklands/residential/apartment/7734988>



**William Shen**  
03 8686 8388



**Kailey Wang**  
03 8686 8388

# 1406/9 Waterside Place, Docklands

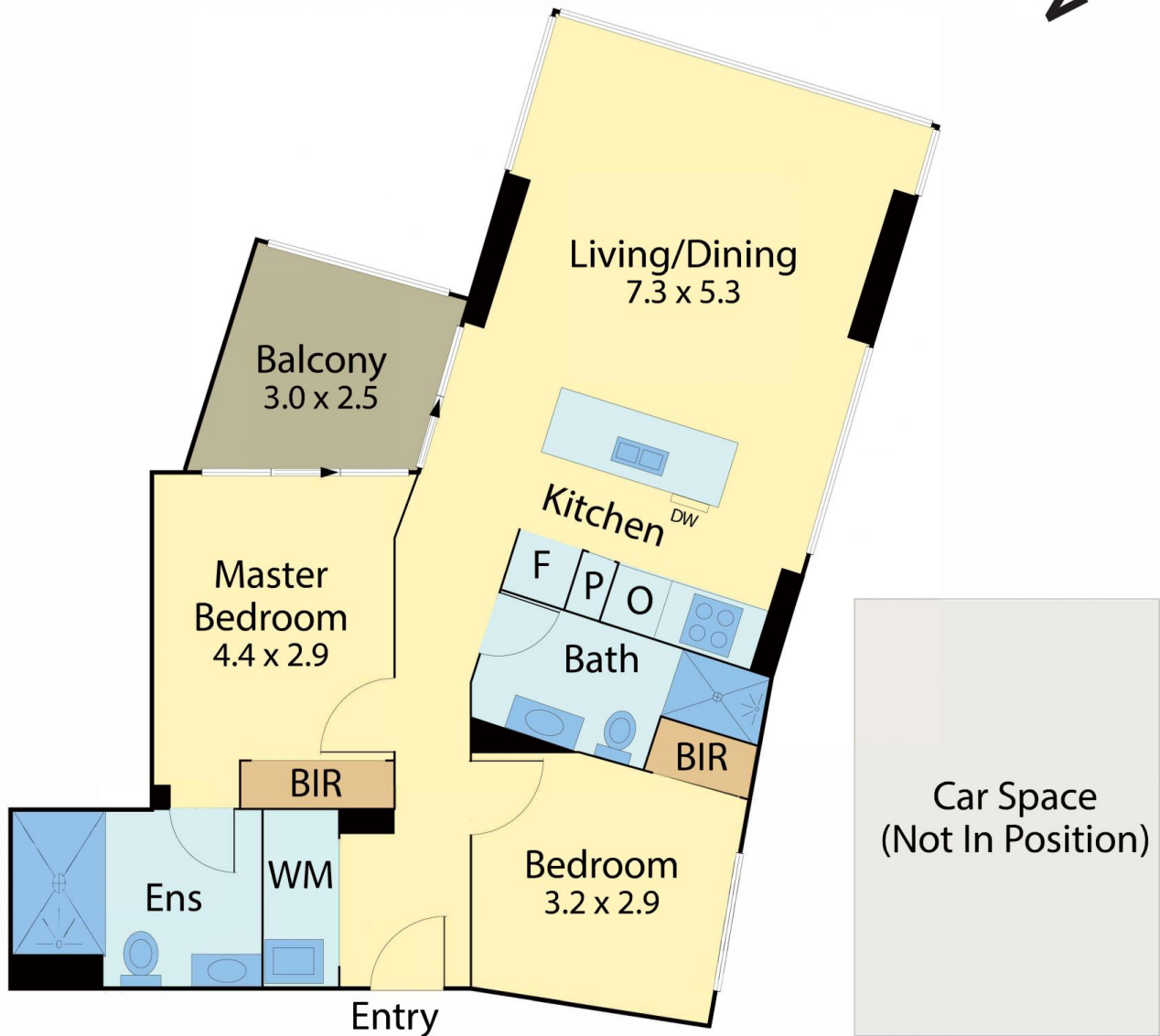

Internal 88 m<sup>2</sup> (9.5 squares) Approx.  
Balcony 8 m<sup>2</sup> (0.9 squares) Approx.



All measurements are in metres. This plan is not to scale and provided as marketing material. All measurements are approximate and for illustrative purposes only. We make no guarantee of the accuracy of the plan, and you should independently determine the suitability of the property for your requirements.